

SmartBook 2.0

SmartBook 2.0 adaptively aids students to study more efficiently by highlighting where in the chapter to focus, asking review questions and pointing them to resources until they understand.

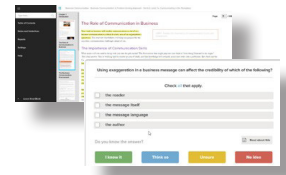

Guided Examples

Narrated, animated, step-by-step walk-throughs for select exercises feature algorithmic variants of assignable content. Shown as "hints" in the student view. Can be turned off and on by instructors.

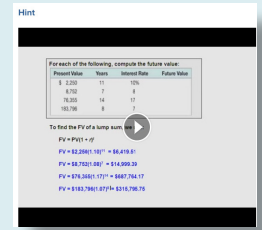

Corporate Finance Videos

Assignable, animated videos with 3 accompanying questions help students understand the key learning objectives. These dynamic videos are between 2-5 minutes in length and are especially helpful to keep students engaged and those who would like additional review outside of the text.

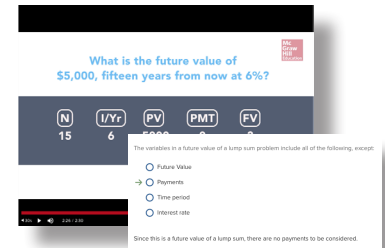

Corporate Finance Prep

Prep Courses cover the basic concepts in Math, Statistics, Accounting, Excel, Calculators, and Economics, and are comprised of animated tutorial modules with quiz questions. Instructors can assign as homework or include for optional practice. Prep Courses provide a level playing field, give instructors more time in class to cover finance topics, and ensure that students do not get left behind.

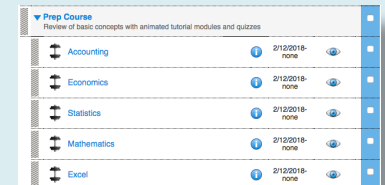

Excel Simulations

Assignable within Connect Finance, these simulations allow students to practice their Excel skills, including financial formulas and functions. The questions feature animated, narrated Help and Show Me tutorials (when enabled) and automatic feedback and grading. Feedback and grading for both students and professors. Excel Simulation problems are available with select Corporate Finance, MBA Corporate Finance, and Investments titles.

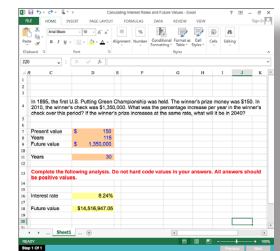

End-of-Chapter Content

Connect Finance helps students learn more efficiently by providing feedback and practice material when they need it, where they need it. Our assignable, gradable end-of-chapter content helps students learn to solve problems and apply the concepts in finance. Algorithmic versions allow students to practice problems as many times as they need, to ensure that they fully understand each problem.

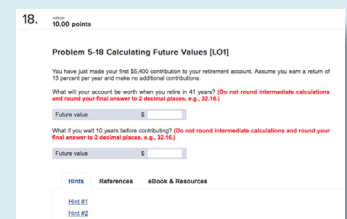

Interactives

Interactive Data Problems allow students to visualize and interact with data in different ways. Students use this tool to manipulate data and answer a variety of accompanying problems that test multiple levels of understanding.

